



Millhaven Close

, Romford, RM6 4PN

£250,000

Redbridge

C



GROUND FLOOR FLAT - NO CHAIN

Welcome to this charming two-bedroom ground floor flat located in the desirable Millhaven Close, Romford. This property is presented in great condition, making it an ideal choice for first-time buyers or those seeking a sound investment opportunity.

As you enter the flat, you will appreciate the spacious layout that maximises comfort and functionality. The two well-proportioned bedrooms offer ample space for relaxation and rest, while the inviting living area provides a perfect setting for entertaining guests or enjoying quiet evenings at home. The flat's modern design and tasteful decor create a warm and welcoming atmosphere throughout.

One of the standout features of this property is the allocated parking, which adds convenience and ease to your daily routine. With a long lease of 148 years, you can enjoy peace of mind knowing that your investment is secure for many years to come.



COMMUNAL ENTRANCE

Flat is on the ground floor.

ENTRANCE TO FLAT

RECEPTION ROOM 15'9" x 11'4" (4.82m x 3.47m)

Double glazed window. Laminate flooring. Heater. Open to kitchen.

KITCHEN 8'9" x 8'6" (2.68m x 2.61m)

Tiled flooring. Gas cooker. Extractor hood. Oven. Space for fridge-freezer, Washing machine and Dish washer. Double glazed window. Open to Reception room.

BEDROOM ONE 12'9" x 9'1" (3.91m x 2.79m)

Double glazed window. Carpeted flooring. Heater.

BEDROOM TWO 8'11" x 6'10" (2.73m x 2.10m)

Double glazed window. Carpeted flooring. Heater.

BATHROOM 6'9" x 5'4" (2.06m x 1.65m)

Tiled flooring and Radiator. Panel bath. Wash hand basin. Low level toilet.

AGENTS NOTE

No services or appliances have been tested by Sandra Davidson Estate Agents.

Area Map

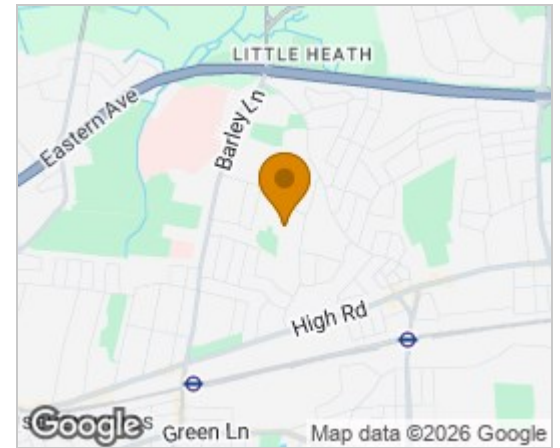

Floor Plans

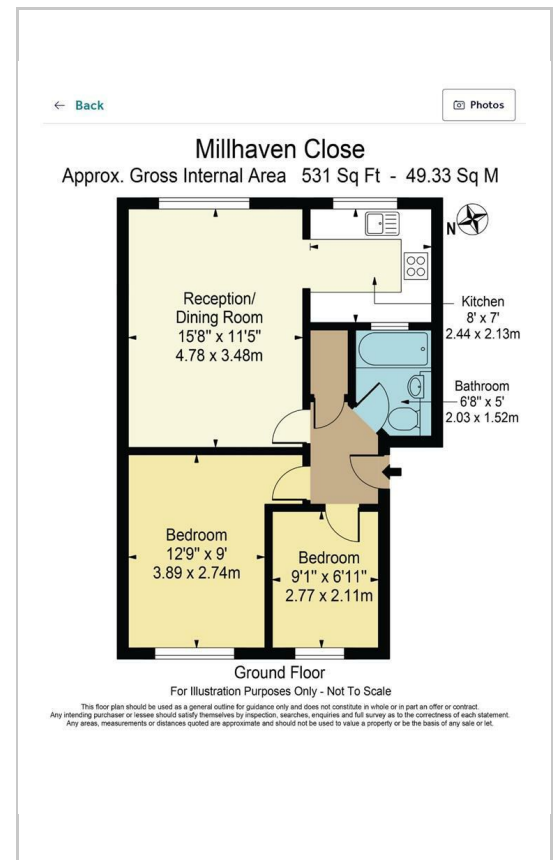

Energy Efficiency Graph

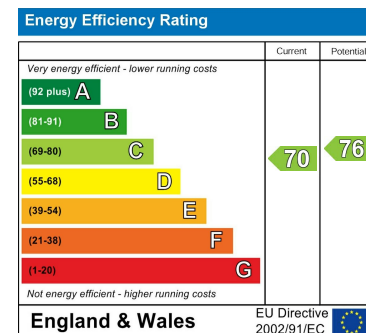

These particulars, whilst believed to be accurate are set out as a general outline only for guidance and do not constitute any part of an offer or contract. Intending purchasers should not rely on them as statements of representation of fact, but must satisfy themselves by inspection or otherwise as to their accuracy. No person in this firm's employment has the authority to make or give any representation or warranty in respect of the property.

353 Green Lane, Seven Kings, Essex, IG3 9TH

Tel: 020 8597 7372 Email: sevenkings@sandradavidson.com <https://www.sandradavidson.com>